

WIWA paint spraying equipment with maximum performance at minimum cost for trade and industry

PHOENIX

PHOENIX –
the new high-performance,
multi-purpose unit for
painting wood and metal,
as well as other coating
applications.

| For medium- and low-viscosity materials | | |
|---|-----------|--------------|
| Pressure Ratio | Output* | Model |
| 30:1 | 40 (2.44) | 6530 N/R/RS |
| 18:1 | 72 (4.39) | 11018 N/R/RS |
| 32:1 | 72 (4.39) | 11032 N/R/RS |

| For high-viscosity paint and coating materials | | |
|--|-----------|-------------|
| Pressure Ratio | Output* | Model |
| 52:1 | 40 (2.44) | 6552 N/R/RS |

*per double-stroke in ccm (cu. in.)

N = non-stainless
R = corrosion resistant
RS = stainless steel



WIWA PHOENIX Hot Job
Hot-Spray Equipment



WIWA PHOENIX Air Combi
Coating Equipment



The new WIWA generation
for varied painting and
coating tasks:

■ **WIWA PHOENIX**
Airless

Sturdy airless spraying
equipment for cost-
efficient coatings

■ **WIWA PHOENIX**
Air Combi

For extremely fine
finishes using environ-
mentally friendly air-
combi technology

■ **WIWA PHOENIX**
Hot Job

Hot-spray equipment
for shorter curing
times and top quality
finishes



WIWA PHOENIX Airless
Spraying Equipment



WIWA PHOENIX –
traditional WIWA quality and
high-performance ensure success

UNIQUELY VERSATILE...

The new WIWA PHOENIX series is a versatile, high-quality pump system for virtually all areas of application in trade and industry.

Ideal for the wood- and metal-working industries as well as for painting and finishing shops and the technical trades.

Diverse performance levels and configurations provide for excellent coverage of small and large surfaces and a variety of shapes and edges.

Suited for various application techniques for maximum versatility:

- Airless spraying
- Air Combi spraying
- Hot Spray

The basis for all these equipment variations is the new PHOENIX series high-pressure pumps, a further refinement of our extremely successful previous models using the latest developments from the coatings industry.

The new WIWA PHOENIX Series leaves nothing to be desired.



The **WIWA PHOENIX Series**
for quiet, trouble-free
operation.

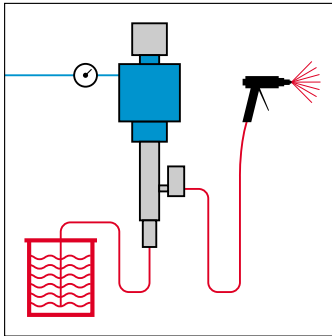

PHOENIX Airless Spraying Equipment

Airless

High-pressure spraying

Economical, environmentally friendly spraying method with high surface area coverage.

The fluid pump draws coating material from any desired container and transfers it under high pressure through a hose to the spray gun. A specially formed spray tip provides for airless atomization. A high-velocity stream of material is then sprayed onto the object being coated, which insures fantastic surface coverage.

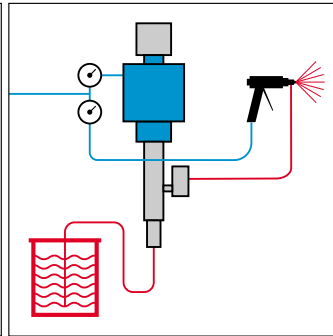

PHOENIX Air Combi Spraying Equipment

Air Combi

Air-assisted painting technology

The Air Combi spraying method combines the advantages of the Airless and conventional spraying techniques.

Under this method, coating material is transferred under moderate pressure to the spray gun and pre-atomised. Through the regulated supply of compressed air to the sprayed material, a soft, controllable stream with minimal overspray is produced. This is ideal for applications requiring fine finishes for complex profiles having small or large surface areas.

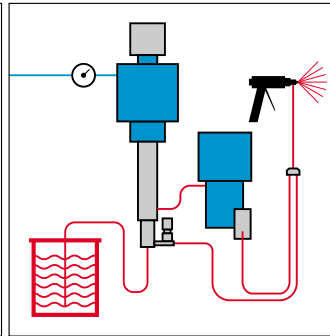

PHOENIX Hot Job Spraying System

Hot-Spray

For higher film builds, shorter drying time, and finest finish quality.

WIWA Fluid Heaters can control material viscosity, thereby eliminating the use of reducing solvents. An adjustable circulation system maintains a constant material temperature.

Airless Spraying Method

- Superb coverage performance
- Saves material and solvent
- High coating thickness in one pass
- Saves energy through lower air consumption
- Closed, uniform spray pattern
- Minimized overspray
- Explosion-proof due to pneumatic operation

Air Combi Spraying Method

- High material savings
- Fine atomization insures first-class finishes
- Low operating cost due to minimal air consumption
- Soft, controllable spray pattern
- Low pump wear due to lower operating pressures

Hot Job Hot-Spray Method

- Excellent surface coverage
- Shorter drying times
- High coating thickness
- Trouble-free operation with high-viscosity materials
- Environmentally- and user-friendly as solvent use is eliminated
- Improved finishes due to better dispersion of paint



All PHOENIX pumps are equipped standard with high-pressure filters.



A dual pressure regulator provides spraying pressure and atomising air for the Air Combi version.



A return valve provides a constant spray temperature when using the Hot Spray version with circulation system.

WIWA PHOENIX –
the ideal spraying and coating
technology ...

... FOR EVERY APPLICATION

Thanks to diverse performance levels and configurations, the WIWA PHOENIX Series offers individual solutions for each application.



Hot Job hot-spray technique



Coating wooden window-frames
with Air Combi system



Coating metal with Airless spray
painting equipment.



WIWA's training program can
help your operators get the
most out of your equipment
purchase.

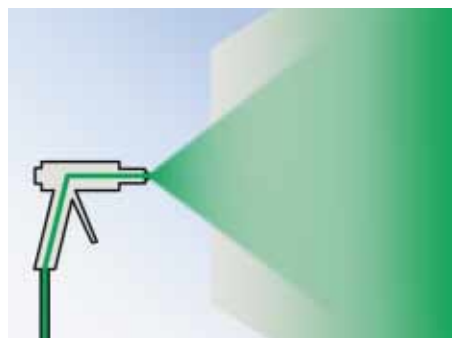

Airless spraying technology
for cost-effective coating of large surfaces.

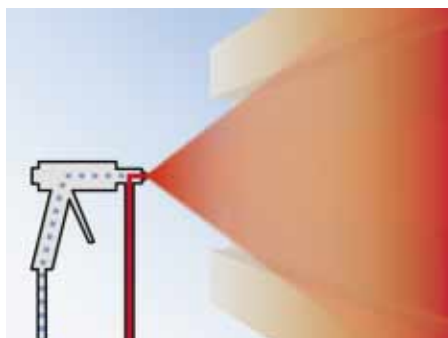

Air Combi spraying technology
for the finest finishes and for formed or small workpieces.

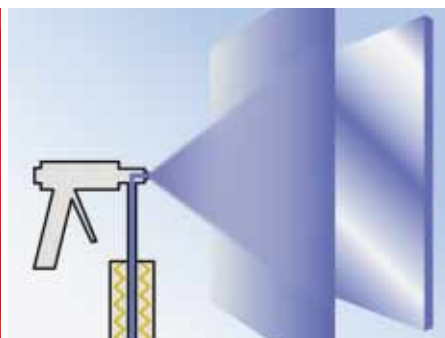

Hot Job hot-spray technology
for shorter drying times and top quality finishes.

Areas of application for PHOENIX coating equipment

| We suggest: | PHOENIX Airless Spraying Equipment | | | | PHOENIX Air Combi Spraying Equipment | | | | PHOENIX Hot Job Hot-spray Equipment | | | |
|---|------------------------------------|---------------|--------------|--------------|--------------------------------------|---|--------------|--------------|-------------------------------------|---------------|--------------|--------------|
| Model | 6530 | 6552 | 11018 | 11032 | 6530 | – | 11018 | 11032 | 6530 | 6552 | 11018 | 11032 |
| Pressure ratio | 30:1 | 52:1 | 18:1 | 32:1 | 30:1 | – | 18:1 | 32:1 | 30:1 | 52:1 | 18:1 | 32:1 |
| Free-flow output, l/min (US gallon/min) | 6.5 (1.72) | 6.5 (1.72) | 11 (2.91) | 11 (2.91) | 6.5 (1.72) | – | 11 (2.91) | 11 (2.91) | 6.5 (1.72) | 6.5 (1.72) | 11 (2.91) | 11 (2.91) |
| Output per cycle, ccm (cu.in.) | 40 (2.44) | 40 (2.44) | 72 (4.39) | 72 (4.39) | 40 (2.44) | – | 72 (4.39) | 72 (4.39) | 40 (2.44) | 40 (2.44) | 72 (4.39) | 72 (4.39) |
| Areas of application | | | | | | | | | | | | |
| Carpentry shops | ■ | □ | ■ | ■ | ■ | | ■ | ■ | ■ | ■ | ■ | ■ |
| Furniture industry | ■ | □ | ■ | ■ | ■ | | ■ | ■ | ■ | ■ | ■ | ■ |
| Paint and coating shops | □ | □ | □ | ■ | ■ | | ■ | ■ | – | ■ | □ | ■ |
| Machine and auto industry | – | – | □ | – | ■ | | ■ | ■ | – | – | ■ | – |
| Steel and building fabrication | □ | □ | □ | □ | – | | – | ■ | – | □ | – | □ |
| Steelworking industry | □ | □ | □ | □ | □ | | □ | □ | □ | □ | □ | □ |
| Automatic or manual coating systems | □ | □ | – | □ | □ | | □ | □ | □ | □ | – | □ |
| Shipbuilding and refitting (interior painting) | □ | □ | – | □ | □ | | □ | □ | □ | □ | – | □ |
| Railcar construction | □ | □ | – | □ | □ | | □ | □ | □ | □ | – | □ |
| Transfer pumps | – | – | ■ | ■ | – | | – | – | – | – | – | – |
| Material to be sprayed | | | | | | | | | | | | |
| Primer | ■ | – | □ | ■ | ■ | | ■ | ■ | □ | □ | □ | □ |
| Spackle | ■ | ■ | – | ■ | – | | – | – | □ | □ | – | □ |
| Sprayable paints and lacquers | ■ | ■ | □ | ■ | ■ | | ■ | ■ | ■ | ■ | □ | ■ |
| Two component and tar-epoxy paints* | ■ | ■ | – | ■ | ■ | | ■ | ■ | □ | ■ | □ | □ |
| Textured paints | ■ | ■ | – | ■ | ■ | | ■ | ■ | □ | □ | – | □ |
| Hammer-tone paint | ■ | ■ | – | ■ | ■ | | ■ | ■ | □ | □ | – | □ |
| Zinc coatings | – | – | – | □ | – | | – | – | □ | □ | □ | □ |
| Rust protection and micaceous iron oxide paints | ■ | ■ | – | ■ | □ | | □ | □ | □ | □ | – | □ |
| Low-solvent and solvent-free paints | – | □ | – | – | – | | – | – | □ | □ | □ | □ |
| Water-based stains | – | – | ■ | – | – | | – | – | – | □ | – | – |
| Water-based paints | ■RS | – | – | ■RS | ■RS | | ■RS | ■RS | – | – | – | – |
| Clear coat paints | ■ | – | – | ■ | ■ | | ■ | ■ | □ | – | – | □ |
| Thick-coat varnishes | ■ | □ | – | ■ | ■ | | ■ | ■ | □ | □ | – | □ |

*high-viscosity and coarsely pigmented

■ very suitable □ suitable – unsuitable

Existing Airless equipment can be easily converted to Air Combi or Hot Spray.

The new **WIWA PHOENIX Series** –
a new standard of quality with
convincing attributes.

THE BASIS OF SUCCESS

Modern design and long service life are the requirements for successful and economical operation.

WIWA's decades of experience and constant development in close cooperation with paint manufacturers, our innovative design and precision, and the fact that many of our pump's components are manufactured in-house bring great advantages to our customers.

Compact and well conceived

Fast assembly due to fewer pieces.

Selected, high-grade materials reduce wear and therefore repair costs.

The adjustment of the pressure ratio or output for different applications is possible through the exchange of a few components, reducing additional investment costs.

All PHOENIX Series pumps are available in corrosion-resistant models which are ideal for water-based coatings.

The PHOENIX 6552 is capable of processing highly viscous materials due to its high pressure ratio.

The PHOENIX 6552 with funnel is ideal for repair work in corrosion protection when small amounts of material are used.

- Double acting pump with long stroke and fixed packings.
- Maintenance-free, low-noise air motor.
- Thorough cleaning due to innovative pump design.
- A closed lubrication chamber separates the air motor from the fluid pump. The lubricant prevents paint from drying onto the piston rod and protects the packings.
- Trouble-free processing of high-viscosity materials due to large diameter valves and material passages.
- Minimal wear and lower repair costs due to self-adjusting packings.
- Longer service life due to hard-chromed dual pistons, tungsten carbide valve seats and stainless steel balls.
- Trouble-free operation due to double filter system.
- Over-sized air passages and a new control system insure a rapid changeover of the air motor, practically eliminating pulsation of the spray stream and icing of the motor.
- Effective in application through simultaneous operation of several spray guns, depending on the tip sizes used.
- Environmentally-friendly, low-noise operation due to the optimised control system and the large built-in muffler.



WIWA 3500

Explosion-proof fluid heater for WIWA Hot Job hot-spray equipment.

Also suitable for water-based coatings, as all parts which come in contact with the coating material are corrosion-resistant. The robust and functional construction is remarkable due to the modular design.

In case the heat exchanger becomes blocked by hardened material, it can be easily removed from the heating and control elements for immediate replacement.



The icing of the air motor is practically eliminated due to the built-in **air maintenance unit**.

Design Features of the PHOENIX Series

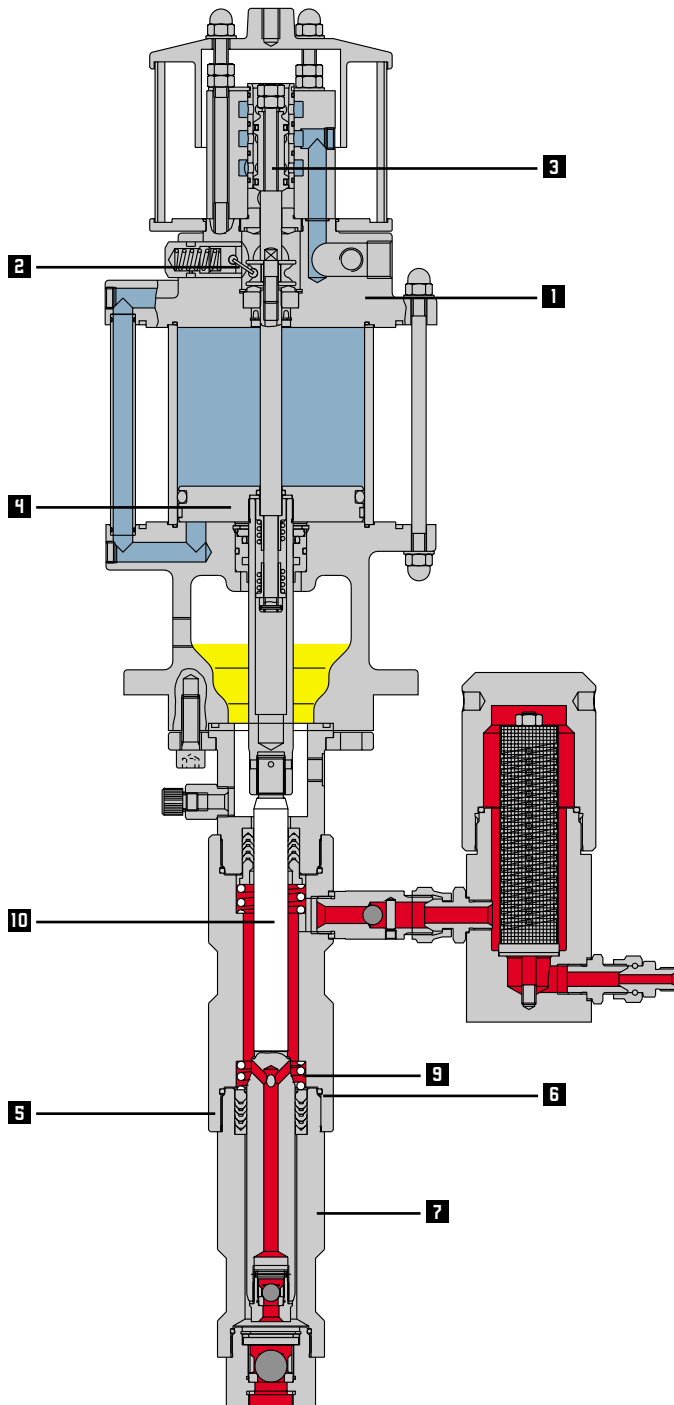

Air Motor:

- 1** Due to the small number of individual components, the motor is easy to assemble and disassemble.
- 2** The toggles are well visible, and therefore easy to install.
- 3** Pulsation is controlled by the high change-over speed on the air motor.
- 4** Variable performance ratings are possible by changing the diameter of the piston in the air motor.

■ **Maintenance-free, low-noise air motor**

■ **Easy servicing due to the small number of individual components**

■ **Flexible adaptation for different performance requirements**

Fluid Pump:

- 5** Quick assembly and disassembly due to swivel nuts and direct screwed fittings. When disassembling the pump, the parts separate automatically.
- 6** Sealing rings placed before the threads prevent them from clogging and facilitate disassembly.
- 7** Precision guiding ensures simple and exact alignment of the components, as well as less wear and tear.
- 8** Less pressure loss due to large bores and extra large fluid passages.
- 9** Better rinsing due to large fluid passages and short packing retention springs.
- 10** Variable output and pressure ratios are possible through exchanging piston rod and packings.

■ **Pulsation is controlled by the high change-over speed on the air motor**

■ **Compact and versatile**

■ **Less wear and tear due to spring supported, self-regulating packings**

■ **Easy assembly ensures quick maintenance**

Multi-purpose units for trade and industry. Spraying equipment designed for long-term use.

WIWA PHOENIX SERIES P FINISHING EQUIPMENT

| Technical Details: | | | | |
|---|------------|------------|------------|------------|
| Model | 6530 | 6552 | 11018 | 11032 |
| Max. free-flow output, l/min. (US gallon/min) | 6.5 (1.72) | 6.5 (1.72) | 11 (2.91) | 11 (2.91) |
| Pressure ratio | 30:1 | 52:1 | 18:1 | 32:1 |
| Output per cycle, ccm (cu. in.) | 40 (2.44) | 40 (2.44) | 72 (4.39) | 72 (4.39) |
| Max. input air, bar (psi) | 8 (116) | 8 (116) | 8 (116) | 8 (116) |
| Max. operating pressure, bar (psi) | 240 (3480) | 416 (6032) | 144 (2088) | 256 (3712) |
| Piston diameter of air motor, mm (inch) | 105 (4.13) | 140 (5.51) | 105 (4.13) | 140 (5.51) |
| Piston stroke of air motor, mm (inch) | 75 (2.95) | 75 (2.95) | 75 (2.95) | 75 (2.95) |

| Version | N | R | RS | N | R | RS | N | R | RS | N | R | RS |
|---------|---|---|----|---|---|----|---|---|----|---|---|----|
|---------|---|---|----|---|---|----|---|---|----|---|---|----|

PHOENIX Airless Spraying Equipment

| | | | | | | | | | | | | | |
|-------------------------------------|----------|---------|---------|---------|---------|---------|---------|---------|---------|---------|---------|---------|---------|
| with cart | part no. | 0641351 | 0641352 | 0641353 | 0641357 | 0641358 | 0641359 | 0641363 | 0641364 | 0641365 | 0641369 | 0641370 | 0641371 |
| with wall-mount | part no. | 0641354 | 0641355 | 0641356 | 0641360 | 0641361 | 0641362 | 0641366 | 0641367 | 0641368 | 0641372 | 0641373 | 0641374 |
| with feed funnel | part no. | 0642126 | – | – | 0642137 | 0642138 | – | – | – | – | – | – | – |
| with "Ready to Spray" accessory kit | part no. | 0642474 | 0642474 | 0629957 | 0642476 | 0642476 | 0629957 | 0642474 | 0642474 | 0629957 | 0642475 | 0642475 | 0629957 |

PHOENIX Air Combi Spraying Equipment

| | | | | | | | | | | | | | |
|---|----------|---------|---------|---------|---|---|---|---------|---------|---------|---------|---------|---------|
| with cart | part no. | 0641379 | 0641380 | 0641381 | – | – | – | 0641391 | 0641392 | 0641393 | 0641397 | 0641398 | 0641399 |
| with wall-mount | part no. | 0641382 | 0641383 | 0641384 | – | – | – | 0641394 | 0641395 | 0641396 | 0641400 | 0641401 | 0641402 |
| Spraying Gun, max. 250 bar (3625 psi), with tip | part no. | 0632578 | 0632578 | 0632578 | – | – | – | 0632578 | 0632578 | 0632578 | 0632578 | 0632578 | 0632578 |

PHOENIX Hot Job Hot-Spray System

| | | | | | | | | | | | | | |
|-------------------------------------|----------|---------|---------|---------|---------|---------|---------|---------|---------|---------|---------|---------|---------|
| with cart | part no. | 0641497 | 0641498 | 0641499 | 0641385 | 0641386 | 0641387 | 0641503 | 0641504 | 0641505 | 0641509 | 0641510 | 0641511 |
| with wall-mount | part no. | 0641500 | 0641501 | 0641502 | 0641388 | 0641389 | 0641390 | 0641506 | 0641507 | 0641508 | 0641512 | 0641513 | 0641514 |
| with "Ready to Spray" accessory kit | part no. | 0642477 | 0642477 | 0642478 | 0642477 | 0642477 | 0642478 | 0642477 | 0642477 | 0642478 | 0642477 | 0642477 | 0642478 |

N = non-stainless
R = corrosion resistant
RS = stainless steel

PAINT SPRAYING AND

Whether non-stainless (N), corrosion resistant (R) or stainless steel (RS); whether with cart, wall-mount, or filling funnel – the WIWA PHOENIX series is versatility in perfection.

PHOENIX Airless
Spraying equipment with cart and suction hose



PHOENIX Airless
Spraying equipment with filling funnel



PHOENIX Air Combi
Spraying system with wall-mount



PHOENIX Hot Job
Hot-spray system with cart

| "Ready to Spray" accessory kit | 13 | 14 | 15 | 16 | 10 RS | 17 RS |
|--------------------------------|-----------------------------|-----------------------------|-----------------------------|--|------------------------------|--|
| Spraying Gun | WIWA 250 D (with swivel) | WIWA 500 D (with swivel) | WIWA 500 D (with swivel) | WIWA 500 F (with swivel) | WIWA 500 F (with swivel) | WIWA 500 F (with swivel) |
| Spraying Hose | NW 6/410 bar/ 1/4"/7,5 m | NW 6/410 bar/ 1/4"/7,5 m | NW 6/600 bar/ 1/4"/7,5 m | 2x NW6/410 bar/ 7,5 m 1x NW4/410 bar/ 1,0 m | NW 6/410 bar/ 1/4"/7,5 m | 2x NW6/410 bar/ 7,5 m 1x NW4/410 bar/ 1,0 m |
| Return Manifold | – | – | – | Manifold 3x 1/4" | – | Manifold 3x 1/4" -RS- |
| Reversible Guard | – | REV-GUARD™ | REV-GUARD™ | – | – | – |
| Tip | Tip 40°- 0.28 mm | Tip 621 | Tip 621 | Standard tip 65°- 0.53 mm | Standard tip 65°- 0.33 mm | Standard tip 65°- 0.38 mm |
| Part no. | 642474 | 642475 | 642476 | 642477 | 0629957 | 642478 |

Quality German Products –
proven a thousand times
over in daily use:

WIWA AIRLESS AND AIR-C

WIWA Airless Spray Guns

■ Suitable for all materials
which can be sprayed.

■ For use with all known
Airless systems.

■ All common tips and tip
cleaning equipment can be
used.



WIWA 250 D Spray Gun

Convenient Airless spray gun
with easily accessible 2-finger
trigger for fine finishes and
large surface coverage. Opti-
mal maneuverability due to
ball-bearing swivels.



WIWA 500 D High- performance Airless Gun

Includes WIWA swivel and
easily accessible 4-finger trig-
ger for coating large surfaces
and working with protective
gloves.



WIWA 500 F and return manifold for Hot-spray systems

Robust Airless spray gun with
4-finger trigger and front
inlet. Especially recommended
for zinc coatings and other
materials which are abrasive
or settle quickly. Stainless
steel is used for all parts
which come in contact with
the material being sprayed, so
that the 500 F is ideal for use
with water-based coatings.

The front inlet prevents heat-
ing of components which
contact the hand, making the
500 F ideal for the Hot Job
hot-spray method of applica-
tion.

For consistent material tem-
peratures, we recommend the
WIWA hot-spray circulation
system with return manifold.



WIWA 300 Automatic Spray Gun

Robust automatic spray gun
which disengages by way of a
return spring. For faster and
more precise operation, the
gun can be equipped with an
optional pneumatic assist.

The WIWA 300 Automatic
Spray Gun is equipped with a
connection for fluid return
and can be used with or with-
out circulation.



COMBI SPRAY GUNS

WIWA Air Combi Spray Guns



**WIWA Air Combi
Manual Spray Gun**

Easy-to-handle gun for air-assisted spraying with a soft, even stream and minimum overspray. Stainless steel is used for all parts which come in contact with coatings material so that the WIWA Air Combi spray gun is ideal for use with both water-based and solvent-based coatings. Material consumption is reduced due to the continuously adjustable spray pattern.

The maximum operating pressure of 250 bar (3625 psi) allows the WIWA Air Combi Spray Gun to be used as a normal Airless spray gun for coatings as well.



**WIWA Air Combi
Automatic Spray Gun**

High-performance Air Combi automatic spray gun for full- and semi-automatic spraying systems and spraying robots. Similar to the manual gun, stainless steel is used for those parts which come in contact with the material being sprayed, enabling use with both water-based and solvent-based coatings. The spray pattern can be adjusted at the gun or remotely through computer controlled switching and control valves. Individual connections for coatings material and atomising air coupled with two fluid inlets make this gun ideal for single or multi-gun systems.



Airless Spray Guns

- Robust and dependable
- Extremely long service life due to tungsten carbide valve seat, valve needle and ball, as well as an adjustable teflon packing
- Quick disengagement due to short needle travel distance
- Paint- and pressure-bearing components are separated to prevent contamination and binding of the spring – especially important when spraying plural component materials
- Large material passages for trouble-free spraying of high-viscosity and filled materials
- Wear-and-tear parts can be replaced quickly
- The robust, precise and fast disengagement of the automatic gun prevents contamination of the valve needle by way of a cover ring

Air Combi Spray Guns

- Light, handy and robust
- Soft, even spray pattern and reduced material consumption
- Suitable for both water- and solvent-based materials
- Freely adjustable spray stream and atomization
- Swivelling material and air supply connections
- Minimal overspray



**Spray Technology
Fluid Handling Equipment
Made in Germany**

FAX REQUEST

WIWA
Wilhelm Wagner GmbH & Co. KG
Gewerbestraße 1 – 3
P.O.B. 29
D-35631 Lahnau, Germany
E-mail: info@wiwa.de
Internet: <http://www.wiwa.de>
Telephone: +49 (64 41) 6 09-0
Telefax: +49 (64 41) 6 09-50/58

Experience and versatility are the basis of success.

50 years of experience in the fields of spray technology, coatings and fluid handling as well as excellent service guarantee reliable state-of-the-art equipment for our customers.

Continuous development and the extensive know-how of our qualified employees allow WIWA to offer a wide variety of quality products.

Get to know our large range of products:

- ☐ WIWA PROFIT – portable, low-cost spraying equipment for trade and industry.
- ☐ WIWA PROFESSIONAL – our new series for heavy corrosion protection with an extensive program for all types of industrial coatings.
- ☐ WIWA SUPER – well-known for its ruggedness and durability.
- ☐ WIWA HERKULES – our new high-performance series for the heavy corrosion protection and marine industries.
- ☐ WIWA ZINC SILICATE – special airless spraying equipment for water- or solvent-based zinc silicate coatings.
- ☐ WIWA DUOMIX – reliable, high-performance dual component spraying equipment for heavy corrosion protection used world-wide.
- ☐ WIWA Extrusion Pumps
- ☐ WIWA System gratec® – equipment for construction sanitation and repair.
- ☐ WIWA Low Pressure Pumps – for handling all flowable materials.
- ☐ Custom-designed equipment.

Name _____

Company _____

Street _____

Postal Code/Town _____

Phone _____

Fax _____

E-mail _____

Date _____

I am interested in WIWA-products. I request:

- ☐ Information on the equipment marked at the left.
- ☐ Your complete catalog.
- ☐ An appointment for a personal consultation.
- ☐ Information on equipment suited for my application(s):

We would be pleased to provide you with a detailed offer covering all WIWA equipment and related accessories.

Your local distributor is:
